

## Roof Ventilation Design guide for all roof pitches

### 1. **Trussed** Roof Pitches $<15^\circ$ : require 25,000mm<sup>2</sup> per LM airflow

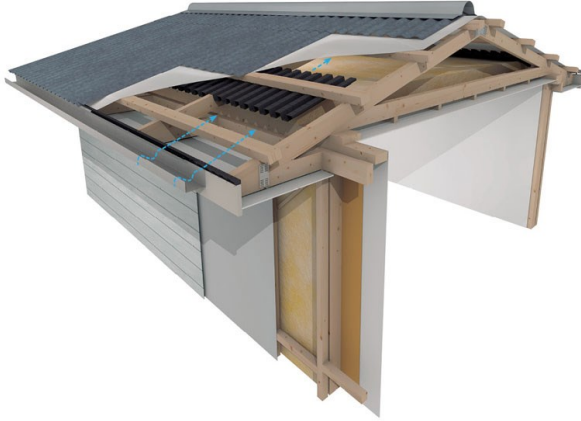

#### For Roof Ventilation use:

1. Over Fascia Vent G2500N
2. Roll Panel Vent G502

#### For Roof Underlay use:

DriStud FRU38 if fire retardancy is required.  
DriStud RU24 if fire retardancy is NOT required.

\* For Preventing bird ingress and nesting insects use Eaves Comb Filler G1275.

### 2. **Trussed** Roof Pitches $15^\circ$ to $30^\circ$ : require 10,000mm<sup>2</sup> per LM airflow

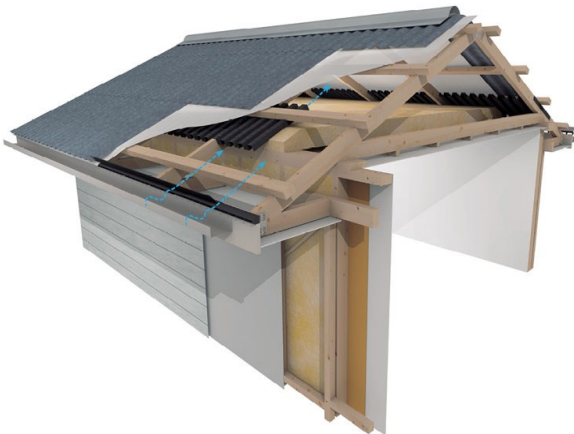

#### For Roof Ventilation use:

1. Over Fascia Vent G1200N
2. Roll Panel Vent G502

#### For Roof Underlay use:

DriStud FRU38 if fire retardancy is required.  
DriStud RU24 if fire retardancy is NOT required.

\* For Preventing bird ingress and nesting insects use Eaves Comb Filler G1275.

### 3. **Trussed** Roof Pitches $>30^\circ$ : require 10,000mm<sup>2</sup> per LM airflow



#### For Roof Ventilation use:

1. Over Fascia Vent G1200N
2. Roll Panel Vent G502
3. Ridge Vent RV10P

#### For Roof Underlay use:

DriStud FRU38 if fire retardancy is required.  
DriStud RU24 if fire retardancy is NOT required.

\* For Preventing bird ingress and nesting insects use Eaves Comb Filler G1275.

TCL Hunt Building Products

## Roof Ventilation Design guide for all roof pitches

### 4. Trussed Mono Pitch Roof

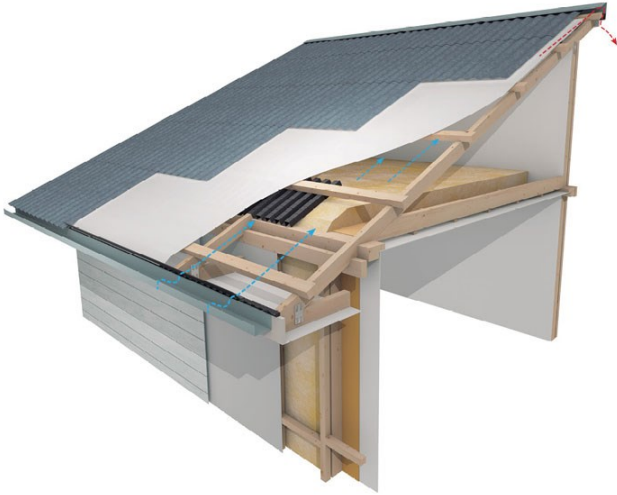

#### For Roof Ventilation use:

1. Over Fascia Vent G1200N for >15 ° or G2500N for <15 ° pitch roof
2. Apron Vent AB20 or AB20DT
3. Roll Panel Vent G502

#### For Roof Underlay use:

DriStud FRU38 if fire retardancy is required.  
DriStud RU24 if fire retardancy is NOT required.

\* For Preventing bird ingress and nesting insects use Eaves Comb Filler G1275.

### 5. SKILLION Roof any degree pitch : require 25,000mm<sup>2</sup> per LM airflow



#### For Roof Ventilation use:

1. Over Fascia Vent G2500N
2. Ridge Vent RV10P or RV10DT or use Apron Vent AB20 or AB20DT for mono pitch roof
3. Vented batten VB20

#### For Roof Underlay use:

DriStud FRU38 if fire retardancy is required.  
DriStud RU24 if fire retardancy is NOT required.

\* For Preventing bird ingress and nesting insects use Eaves Comb Filler G1275.

### Installation Guide

- Terminate Roof Underlay at the ridge purlin or upper purlins to allow airflow.
- Use roll Panel Vent (G502) to ensure minimum air gap of 25mm between the insulation and roof underlays for continuous airflow past the insulation.
- A minimum of 20mm gap between the bottom purlin and Over Fascia Vent is required for air flow into the roof cavity.
- Additional fixing screw length is required to accommodate 20mm thickness of the vented batten, ridge vent or apron vent.
- For Ridge and Apron Vent: Between 17 to 25mm contact with the trough is required. To dress down the soft edge flashing below 5°C, use primer or heat gun to increase the adhesion.

*These diagrams and details are for guidance purposes only.*

*The overall design is the responsibility of the designer as there are often other factors to consider.*

TCL Hunt Building Products

## Vent Product Information

- G1200N: Over Fascia Vent with 10,000mm<sup>2</sup> per LM airflow (10mm ventilator)
- G2500N: Over Fascia Vent with 25,000mm<sup>2</sup> per LM airflow (25mm ventilator)
- RV10P (or AB20) : Ridge (or Apron) Vent for trough less than 38mm
- RV10DT (or AB20DT): Ridge (or Apron) Vent for trough greater than 38mm
- AB20: Apron Vent or Barge Vent for trough less than 38mm
- AB20DT: Apron Vent or Barge Vent for trough greater than 38mm

product Code		Product Description	Pack Quantity	Length per unit (MM)	Total LM per box
VB20		Vented batten (20mm thick)	50	1,800	90.0
G1200N		Over Fascia Vents 10mm	20	1,000	20.0
G2500N		Over Fascia Vents 25mm	20	1,000	20.0
RV10P		Ridge Vent	6	1,200	7.2
RV10DT		Ridge Vent Deep Trough	6	1,200	7.2
AB20		Apron Vent	12	1,200	14.4
AB20DT		Apron Vent DT	12	1,200	14.4
G502		Roll Rafter Tray	2	6,000	12.0
G1275		Eave Comb Filler	50	1,000	50.0
DriStud FRU38		Fire Retardant Vapour Permeable Self Support Synthetic Roof Underlay. Roll size: 1250mm x 40m (50sq), 2500mm x 40m (100sq)			
DriStud RU24		Non-Fire retardant Vapour Permeable Self Support Synthetic Roof Underlay. Roll size: 1250mm x 40m (50sq), 1500mm x 40m (60sq), 2200mm x 50m (110sq)			

## DriStud Roof Underlay Product Information

*Trussed Roof Diagram with DriStud Roof Underlay installation*

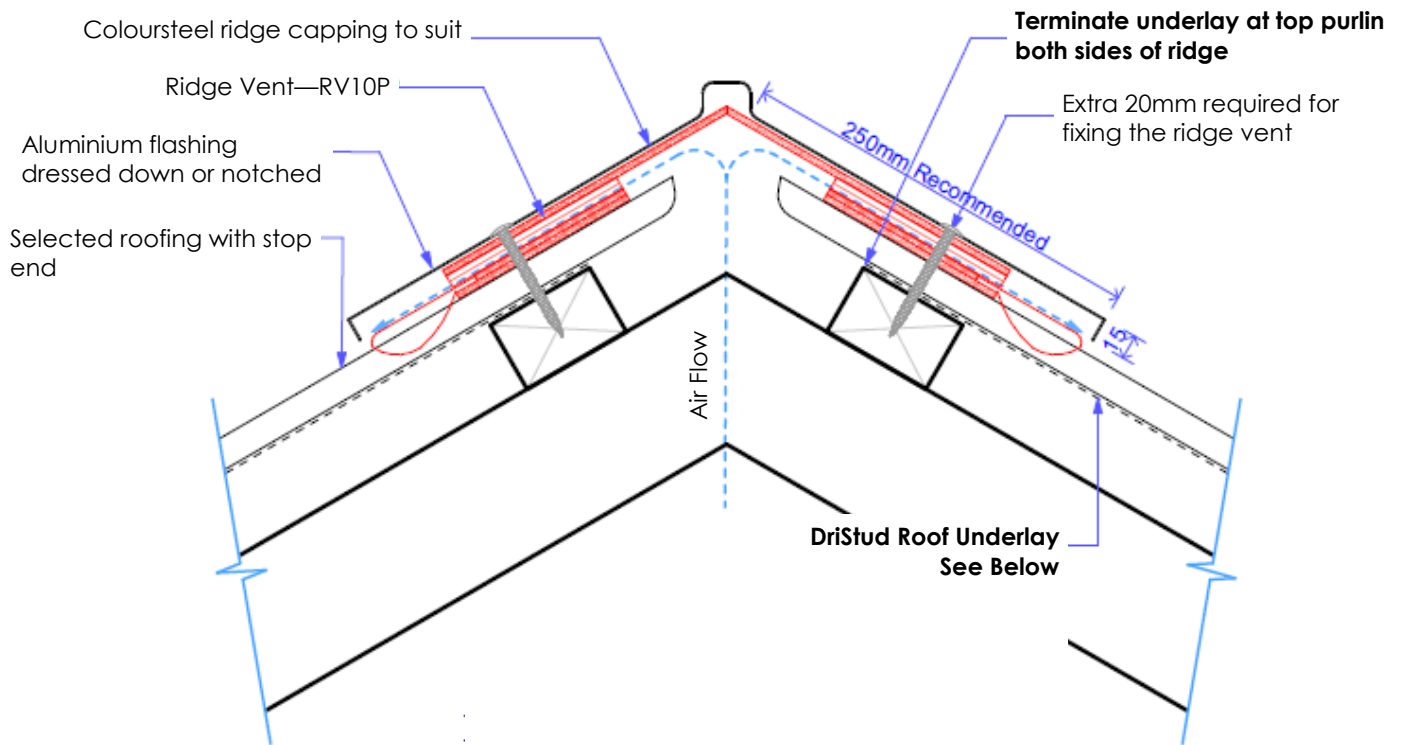

### DriStud Roof Underlay

**DriStud RU24:** Non Fire Retardant Vapour Permeable Self Support Synthetic Roof Underlay.

**DriStud FRU36:** Fire Retardant Vapour Permeable Light Weight Self Support Synthetic Roof Underlay.

**DriStud FRU38:** Fire Retardant Vapour Permeable Heavy Weight Self Support Synthetic Roof Underlay.

DriStud Roof Underlay	Roll Size: width x length (SQ)
<b>RU24</b> (Non-FR SS)	1250mm x 40m (50sq)
	1500mm x 40m (60sq)
	2200mm x 50m (110sq)
<b>FRU36</b> (150gsm FR SS)	1250mm x 40m (50sq)
	1350mm x 55.6m (75sq)
	2700mm x 37.04m (100sq)
<b>FRU38</b> (220gsm FR SS)	1250mm x 40m (50sq)
	2500mm x 40m (100sq)

TCL Hunt Building Products

T 0800 DRISTUD (0800 374 7883)

E technical@dristud.co.nz

W www.dristud.co.nz