

Product Information Sheet

VENT Roll Panel Vent – G502

Description The G502 VENT Roll Panel Vent is designed to maintain a continuous 25mm air gap between the underside of the roofing membrane or sarking board and loft insulation at the eaves, providing a consistent flow of air into the roof space.

The castellated profile is laid across the top of the roof trusses/rafters parallel with the eaves level and is suitable for both new build and roof renovation projects. The extra width of the panel allows for better coverage when low pitch and deep insulation details are encountered.

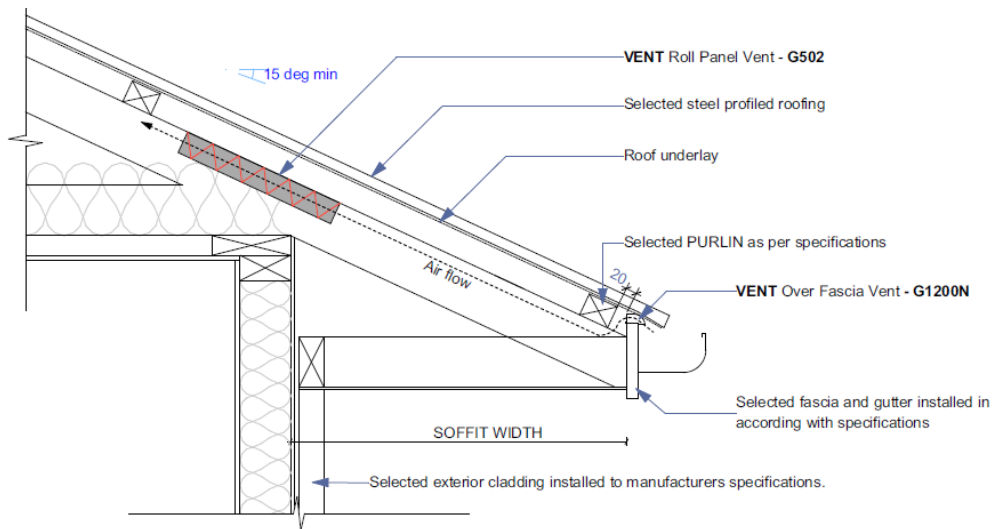
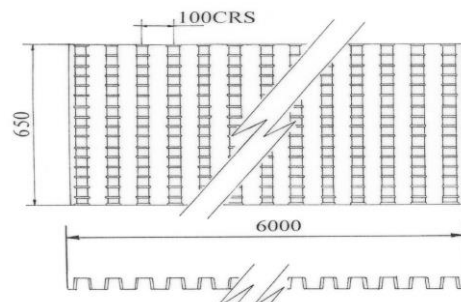

Fig A: Application on trussed roof

Fixing – The G502 VENT Roll Panel Ventilator (A) should be rolled out over the full length of the eaves and adjusted to align with the required roof truss centres then nailed or stapled to secure in position as shown.

This product should be used in conjunction with other soffit/fascia vents to provide a complete passive ventilation system.



Note: These diagrams are for guidance purposes only. The overall design is the responsibility of the designer as there are often other factors to consider.